

Right now, we need your help. Funds are urgently needed. Please consider us in your giving and your prayer support. Additionally, there will be single family and multi-family housing on the property for those who wish to live within the complex, and yet not in apartment style living.

working with the state Certificate of Need Board to change our previous approval on Todds Road to the new site. It is expected in January of 1981.

PROPOSED SITE PLAN - SAYRE VILLAGE

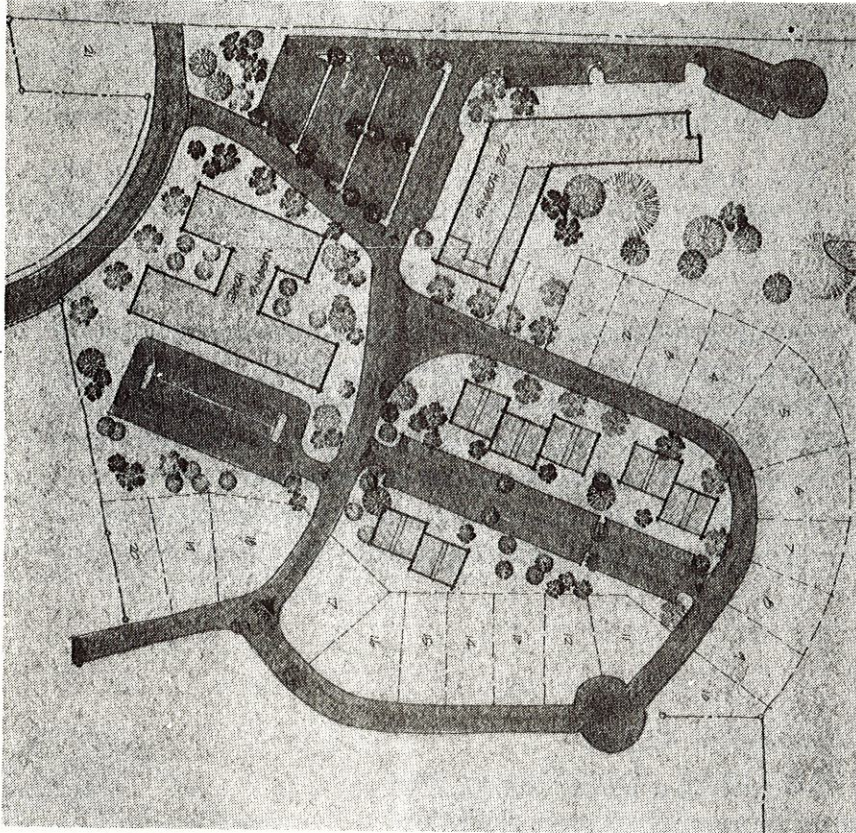

The concept is to care for the elderly, and all of their needs. In addition to the elderly housing apartments, we are also going to complete a 109 bed nursing home on the same site. The nursing home will care for 99 intermediate care residents and 10 personal care residents. We are currently

will come in the summer of 1982.

breakings will be in the Spring. Occupancy spiritual areas. The proposed ground- such as the dining room, and social and building will also house common facilities will have a small kitchen. Additionally, the units, each with a separate bath, and each ninety-two unit elderly housing apart-

The first phase to be built will be the new site.

here pictures the proposed concept on the Todds Road site. The site plan reproduced to work toward the approvals on the old simply was not possible for us to continue the property was completed last month. It Our offices are still located in the Broad- way Christian Church.) The purchase of tion is on Wilson-Downing Road. (Note: Sayre Village has moved. The new loca-

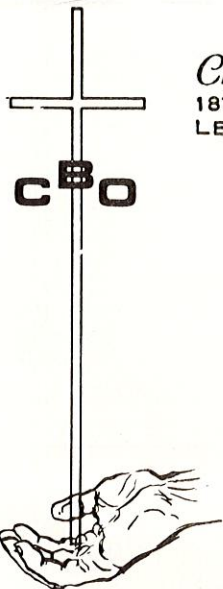

Christian Benevolent Outreach
187 NORTH BROADWAY
LEXINGTON, KENTUCKY 40508

Non profit Org.
U.S. Postage
PAID
Lexington, Ky.
Permit No. 387

LAURA SISK
BOX 135
NOWATA, OKLAHOMA 74048

Address correction requested